

Compressor: B1.5-9.1Y

Refrigerant: R404A

Electrical supply: STANDARD

Performance data

Suction gas temperature = 20,0°C
 Evaporator superheating = 10,0K
 Subcooling = 0,0K
 Operating mode = normal

Legend:

 Additional cooling required

Evaporating temperature	°C	7,5	5,0	0	-5,0	-10,0	-15,0	-20,0
Condensing temperature = 20,0°C								
Refrigerating capacity	kW	-	-	9,34	7,71	6,30	5,08	4,04
Power input	kW	-	-	1,588	1,573	1,530	1,465	1,381
COP		-	-	5,88	4,90	4,11	3,47	2,93
Condensing temperature = 25,0°C								
Refrigerating capacity	kW	11,49	10,52	8,77	7,23	5,90	4,75	3,78
Power input	kW	1,835	1,836	1,813	1,761	1,684	1,589	1,479
COP		6,26	5,73	4,84	4,11	3,50	2,99	2,56
Condensing temperature = 30,0°C								
Refrigerating capacity	kW	10,75	9,83	8,18	6,73	5,48	4,41	3,50
Power input	kW	2,105	2,085	2,022	1,934	1,825	1,701	1,567
COP		5,10	4,72	4,05	3,48	3,00	2,59	2,24
Condensing temperature = 35,0°C								
Refrigerating capacity	kW	9,98	9,13	7,57	6,22	5,06	4,06	3,22
Power input	kW	2,357	2,316	2,215	2,093	1,953	1,803	1,645
COP		4,23	3,94	3,42	2,97	2,59	2,25	1,96
Condensing temperature = 40,0°C								
Refrigerating capacity	kW	9,20	8,40	6,95	5,70	4,62	3,70	2,93
Power input	kW	2,591	2,530	2,392	2,237	2,068	1,892	1,714
COP		3,55	3,32	2,91	2,55	2,23	1,95	1,71
Condensing temperature = 45,0°C								
Refrigerating capacity	kW	8,41	7,66	6,32	5,16	4,17	3,33	2,63
Power input	kW	2,806	2,726	2,553	2,366	2,170	1,970	1,772
COP		3,00	2,81	2,48	2,18	1,92	1,69	1,48
Condensing temperature = 50,0°C								
Refrigerating capacity	kW	7,59	6,91	5,67	4,61	3,71	2,96	2,33
Power input	kW	3,002	2,903	2,697	2,480	2,258	2,036	1,819
COP		2,53	2,38	2,10	1,86	1,64	1,45	1,28
Condensing temperature = 55,0°C								
Refrigerating capacity	kW	6,77	6,14	5,02	4,06	3,25	2,58	2,02
Power input	kW	3,178	3,063	2,824	2,579	2,332	2,090	1,856
COP		2,13	2,01	1,78	1,57	1,39	1,23	1,09

Compressor: B1.5-9.1Y

Refrigerant: R404A

Electrical supply: STANDARD

Performance data

Suction gas temperature = 20,0°C
 Evaporator superheating = 10,0K
 Subcooling = 0,0K
 Operating mode = normal

Legend:

Additional cooling required

Evaporating temperature	°C	-25,0	-30,0	-35,0	-40,0	-45,0
Condensing temperature = 20,0°C						
Refrigerating capacity	kW	3,18	2,46	1,88	1,43	1,07
Power input	kW	1,284	1,178	1,070	0,963	0,862
COP		2,47	2,09	1,76	1,48	1,25
Condensing temperature = 25,0°C						
Refrigerating capacity	kW	2,97	2,30	1,75	1,32	0,99
Power input	kW	1,360	1,236	1,113	0,995	0,888
COP		2,18	1,86	1,58	1,33	1,12
Condensing temperature = 30,0°C						
Refrigerating capacity	kW	2,75	2,12	1,62	1,22	0,90
Power input	kW	1,427	1,287	1,150	1,024	0,911
COP		1,92	1,65	1,41	1,19	0,99
Condensing temperature = 35,0°C						
Refrigerating capacity	kW	2,52	1,94	1,48	1,11	0,82
Power input	kW	1,486	1,331	1,183	1,049	0,932
COP		1,70	1,46	1,25	1,06	0,88
Condensing temperature = 40,0°C						
Refrigerating capacity	kW	2,29	1,76	1,34	1,00	0,73
Power input	kW	1,537	1,368	1,210	1,070	0,951
COP		1,49	1,29	1,11	0,93	0,77
Condensing temperature = 45,0°C						
Refrigerating capacity	kW	2,05	1,58	1,20	0,89	0,65
Power input	kW	1,579	1,398	1,232	1,087	0,968
COP		1,30	1,13	0,97	0,82	0,67
Condensing temperature = 50,0°C						
Refrigerating capacity	kW	1,81	1,39	1,06	0,79	-
Power input	kW	1,612	1,420	1,248	1,100	-
COP		1,12	0,98	0,85	0,72	-
Condensing temperature = 55,0°C						
Refrigerating capacity	kW	1,57	1,21	-	-	-
Power input	kW	1,636	1,435	-	-	-
COP		0,96	0,84	-	-	-

Compressor: B1.5-9.1Y

Refrigerant: R404A

Electrical supply: STANDARD

Performance data

Suction gas temperature = 20,0°C
 Evaporator superheating = 10,0K
 Subcooling = 0,0K
 Operating mode = normal

Legend:  Additional cooling required

Operating limits

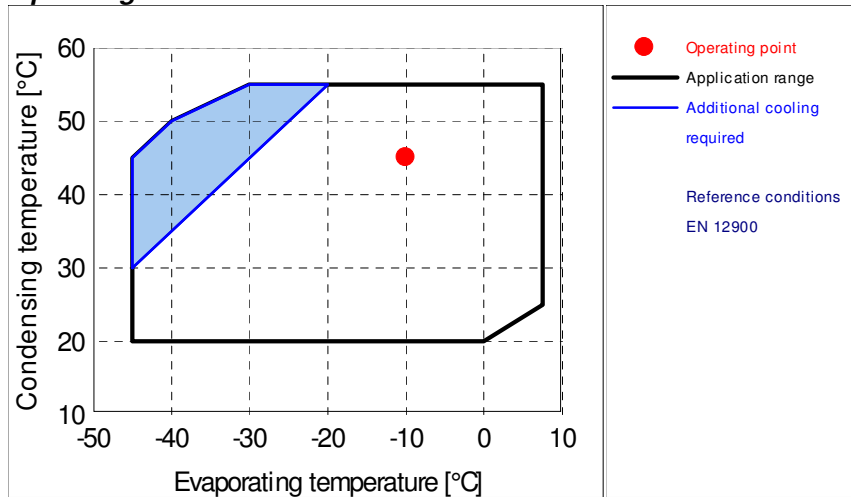

Compressor: B1.5-9.1Y

Refrigerant: R404A

Electrical supply: STANDARD

Performance data

Suction gas temperature	= 20,0°C
Evaporator superheating	= 10,0K
Subcooling	= 0,0K
Operating mode	= normal

Legend:

 Additional cooling required

Dimensions

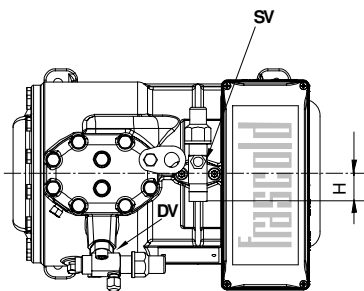
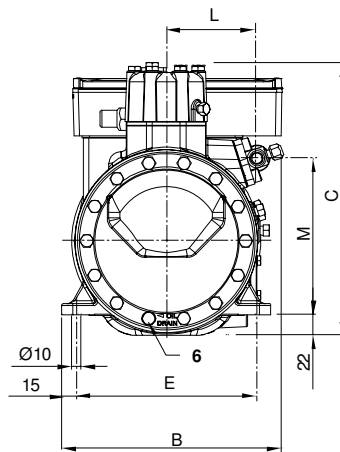
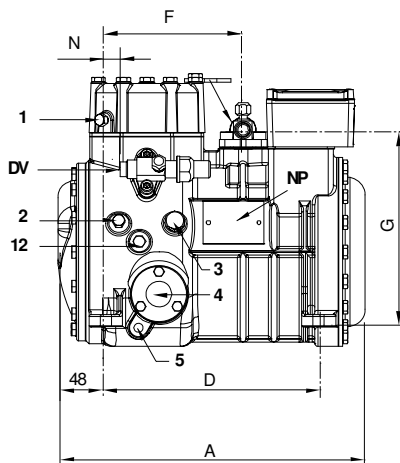

Supporto antivibrante

Vibration absorber

Vibrationsabsorber

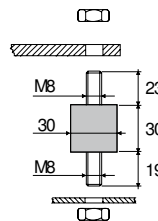

Legend:

B Suction Valve	∅15,8 mm
Discharge valve	∅12,7 mm
A: Length	329mm
B: Width	237mm
C: Height	292mm
D: Base mounting	234mm
E: Base mounting	194mm
F: Suction Valve	150mm
G: Suction Valve	209mm
H: Suction Valve	29mm
L: Discharge valve	97mm
M: Discharge valve	167mm
N: Discharge valve	18mm
1: High pressure plug	
2: Low pressure plug	
3: oil charge plug	
4: oil level sight glass	
5: crankcase heater seat	
6: oil drain plug	
12: oil return plug	
DV: Discharge valve	
SV: Suction Valve	
NP: Nameplate	

Compressor: B1.5-9.1Y

Refrigerant: R404A

Electrical supply: STANDARD

Performance data

Suction gas temperature	= 20,0°C
Evaporator superheating	= 10,0K
Subcooling	= 0,0K
Operating mode	= normal

Legend:

Additional cooling required

Technical data

Make	Reciprocating/ semi-hermetic/ one stage
Nominal operating frequency	50 Hz
Nominal compressor speed @50 Hz	1450 1/min
Nominal displacement @50 Hz	8,96 m ³ /h
Number of pistons	2
Net weight	38 kg
Lubricant	FRASCOLD POE32
Oil charge	1 l
Locked rotor current (LRA)	26,8 A
Maximum allowed operating current (MRA)	5,9 A
Sound power level -10/45°C R404A @50Hz	63,0 dB(A)
Sound power level -35/40°C R404A @50Hz	63,5 dB(A)

Motor connections

Serie **A-B-C-D-F-Q** Series

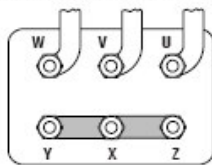

400V
3Ph
50Hz
DOL-STAR

Compressor: B1.5-9.1Y

Refrigerant: R404A

Electrical supply: STANDARD

Performance data

Suction gas temperature = 20,0°C
 Evaporator superheating = 10,0K
 Subcooling = 0,0K
 Operating mode = normal

Legend:

Additional cooling required

Characteristics

Polynomial coefficients according to EN 12900

Coefficient	Refrigerating capacity	Power input	Mass flow
C1	1,14004E+04	5,31840E+02	0,00000E+00
C2*S	4,19597E+02	-3,49519E+01	0,00000E+00
C3*D	-9,30902E+01	5,88598E+01	0,00000E+00
C4*S _c	5,27417E+00	-9,68146E-01	0,00000E+00
C5*S*D	-3,44531E+00	1,85992E+00	0,00000E+00
C6*D _c	-5,46054E-01	-2,98644E-01	0,00000E+00
C7*S _i	2,01895E-02	-6,59669E-03	0,00000E+00
C8*S _c *D	-3,59648E-02	1,53924E-02	0,00000E+00
C9*S*D _c	-7,39925E-03	-6,20564E-03	0,00000E+00
C10*D _i	2,34557E-03	-2,53138E-04	0,00000E+00

Reference conditions:
 Ambient temperature: 32,0 °C
 Suction gas temperature: 20,0 °C
 Liquid subcooling: 0,0 K
 Nominal operating frequency: 50 Hz

Accessories

Accessories	Model	Technical data	
1 Motor protector	ECA01	230V AC	
2 Rubber damper	T00SSA1	30X30 45SH M8 A-B-C	
1 Crankcase heater	T00CH13 A-D	230V	optional
2 Head fan	SZ_FM1 (standard cooling)	230V - 1ph - 50/60 Hz	optional
3 Motor protector INT69 DIAGNOSE	T00ECA01D	115V-230V 50/60 Hz	optional
4 USB adpter for INT69 DIAGNOSE	T00EC57		optional